



USE:

Recommended for suspending rectangular HVAC indoor duct.
Use with #10 self-tapping screws (not included).

Material Specification:

Housing & Plungers: Nickel Plated Brass

Springs: Steel

Ball Bearings: Brass

HX-HV-CLIP (mounting bracket): Zinc Plated Steel

Rubber pads: Neoprene

Wire Rope: Galvanized steel 5/64" - 3/32" 7x7. 1/8" 7x19.

Note: Griplock Systems cannot guarantee working loads with cable that has not been supplied by Griplock Systems.

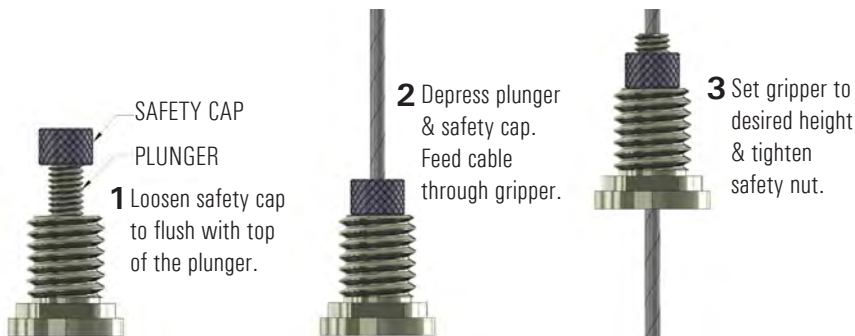

Notes: Minimum 2" cable to exit bottom of gripper when done.
Remove load before adjusting.

- Boot connects directly to rectangular duct
- Pre-attached rubber pads reduce vibration
- Bottom cable exit

ZF-25-SDC

for use with 5/64" - 3/32" cable

ZF-30-SDC

for use with 1/8" cable

Working Load Limit (WLL) 5:1 Safety Factor	5/64"	3/32"	1/8"
	75 lbs	100 lbs	200 lbs

STATIC LOADS ONLY. NOT FOR LIFTING.

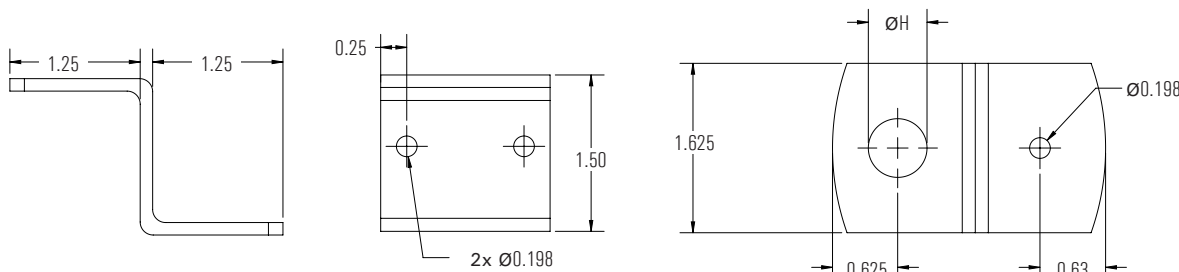

HX-HV-CLIP

(for gripper dimensions, see downward facing strut gripper)

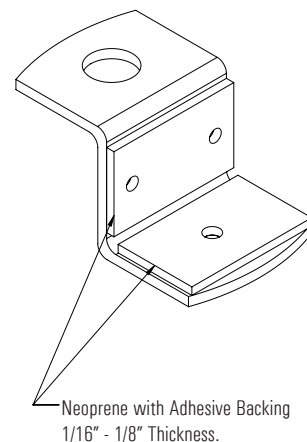

Neoprene with Adhesive Backing
1/16" - 1/8" Thickness.